

| NO. | DOCUMENT ISSUE | DATE |
|-----|----------------|------|
| | | |
| | | |
| | | |
| | | |
| | | |
| | | |
| | | |
| | | |
| | | |
| | | |

| NO. | REVISIONS | DATE |
|-----|-----------|------|
| | | |
| | | |
| | | |
| | | |
| | | |
| | | |
| | | |
| | | |
| | | |
| | | |

PHASE ISSUE BLOCK
**CONSTRUCTION
DOCUMENTS**

SIGNATURE AND SEAL BLOCK

| SHEET TITLE | |
|-------------------|-------------------|
| SITE PLAN | |
| PROJECT ARCHITECT | SYLLA PROJECT NO. |
| JAG | 05003 |
| PROJECT MANAGER | DATE |
| CTS | 5-15-06 |
| DRAWN BY | SHEET NO. |
| CAD | A1-1 |
| CHECKED BY | |
| CTS | |

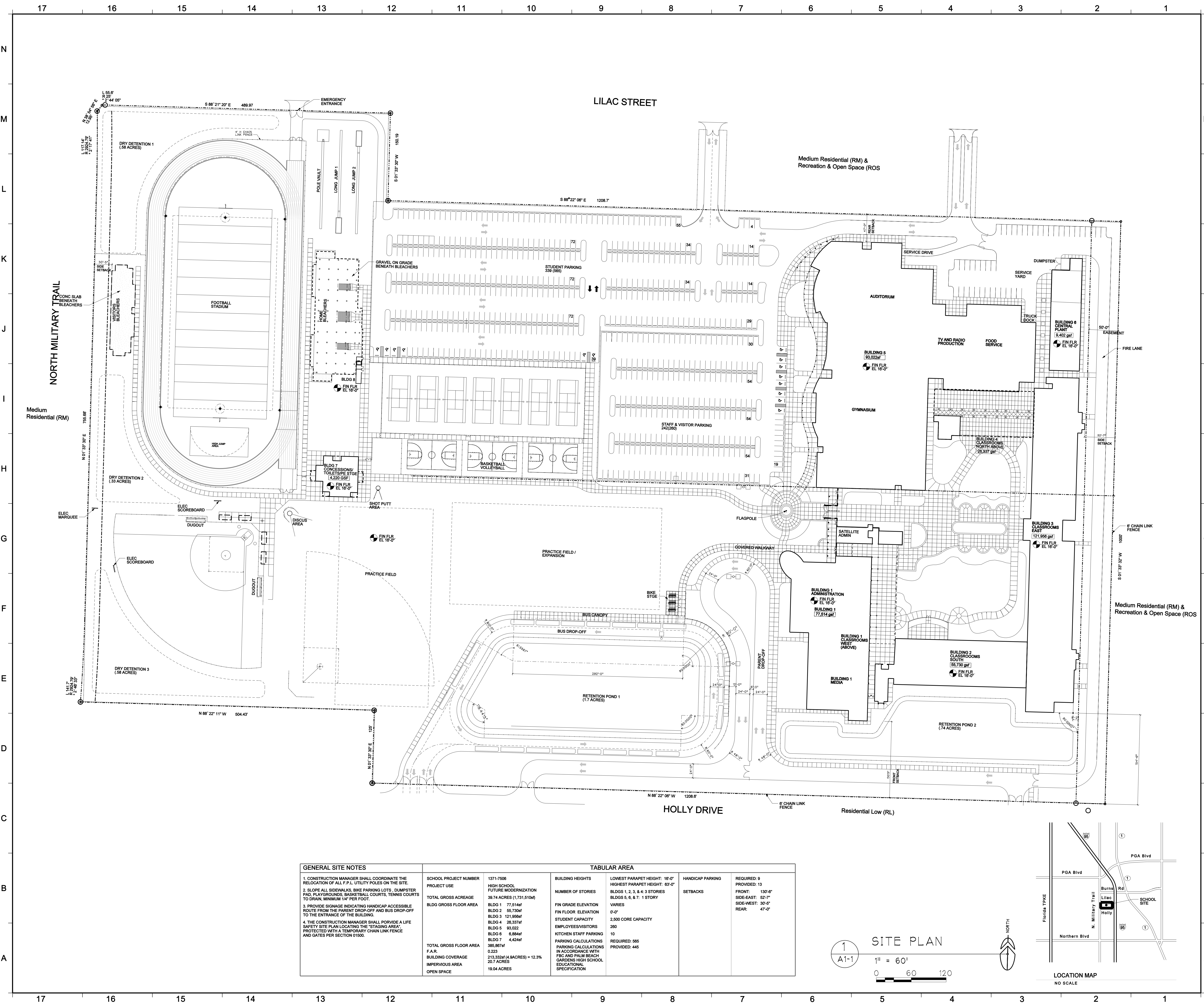

| GENERAL SITE NOTES | | TABULAR AREA | | | |
|---|--|------------------------|----------------------------------|-----------------------|--------------------------------|
| 1. CONSTRUCTION MANAGER SHALL COORDINATE THE RELOCATION OF ALL F.U. UTILITY POLES ON THE SITE. | | SCHOOL PROJECT NUMBER | 1371-7506 | BUILDING HEIGHTS | LOWEST PARAPET HEIGHT: 16'-0" |
| 2. SLOPE ALL SIDEWALKS, BIKE PARKING LOTS, DUMPSTER PAD, PLAYGROUNDS, BASKETBALL COURTS, TENNIS COURTS TO DRAIN, MINIMUM 1/4" PER FOOT. | | PROJECT USE | HIGH SCHOOL FUTURE MODERNIZATION | NUMBER OF STORIES | HIGHEST PARAPET HEIGHT: 63'-0" |
| 3. PROVIDE SIGNAGE INDICATING HANDICAP ACCESSIBLE ROUTE FROM THE PARENT DROP-OFF AND BUS DROP-OFF TO THE ENTRANCE OF THE BUILDING. | | TOTAL GROSS ACREAGE | 39.74 ACRES (1,731,510sq ft) | FIN GRADE ELEVATION | BLDGS 1, 2, 3, & 4: 3 STORIES |
| 4. THE CONSTRUCTION MANAGER SHALL PROVIDE A LIFE SAFETY SITE PLAN LOCATING THE "STAGING AREA", PROTECTED WITH A TEMPORARY CHAIN LINK FENCE AND GATES PER SECTION 01500. | | BLDG GROSS FLOOR AREA | | FIN FLOOR ELEVATION | BLDGS 5, 6, & 7: 1 STORY |
| | | BLDG 1 | 77,514sf | STUDENT CAPACITY | 2,500 CORE CAPACITY |
| | | BLDG 2 | 55,730sf | EMPLOYEES/VISITORS | 280 |
| | | BLDG 3 | 121,566sf | KITCHEN STAFF PARKING | 10 |
| | | BLDG 4 | 28,337sf | PARKING CALCULATIONS | REQUIRED: 565 |
| | | BLDG 5 | 93,022sf | PARKING CALCULATIONS | PROVIDED: 445 |
| | | BLDG 6 | 8,884sf | | |
| | | BLDG 7 | 4,424sf | | |
| | | TOTAL GROSS FLOOR AREA | 385,867sf | | |
| | | F.A.R. | 0.223 | | |
| | | BUILDING COVERAGE | 213,323sf (4 ACRES) = 12.3% | | |
| | | IMPERVIOUS AREA | 20.7 ACRES | | |
| | | OPEN SPACE | 19.04 ACRES | | |

1
SITE PLAN
1" = 60'
0 60 120

